



INSTRUCTION BULLETIN

No. 9013087
Machine: Sentinel
Published: 04-2015
Rev. 00

NOTE: DO NOT DISCARD the Parts List from the Instruction Bulletin. Place the Parts List in the appropriate place in the machine manual for future reference. Retaining the Parts List will make it easier to reorder individual parts and will save the cost of ordering an entire kit.

NOTE: Numbers in parenthesis () are reference numbers for parts listed in Bill of Materials.

Installation instructions for **kit number 9013078**

SYNOPSIS:

This kit contains the parts needed to replace the windshield washer tank on Sentinel sweepers.
Please follow step-by-step instructions.

SPECIAL TOOLS / CONSIDERATIONS: NONE

(Estimated time to complete: 1 hour)



PROTECT THE ENVIRONMENT

Please dispose of packaging materials, used machine components such as batteries and fluids in an environmentally safe way according to local waste disposal regulations.

Always remember to recycle.

PREPARATION:

FOR SAFETY: Before leaving or servicing machine, stop on level surface, turn off machine, set parking brake, and remove key.

1. Disconnect the battery cables from the battery.



WARNING: Always disconnect battery cables from machine before working on electrical components.

INSTALLATION:

1. Disconnect the hose and main wire harness from the windshield washer bottle.
2. Remove the windshield washer bottle and bottle bracket from the engine door bracket. Discard the windshield washer bottle, bottle bracket, and mounting hardware. (Fig. 2)
3. Remove the bracket from the new windshield washer bottle (2). (Fig. 2)
4. Use two M6 hex screws (3) to install the bracket removed from the windshield washer bottle (2) onto the bracket (1). (Fig. 2)

5. Install the windshield washer bottle (2) back onto the windshield washer bottle bracket. (Fig. 2)
6. Use two M6 hex screws (3) and two Belleville washers (4) to install the windshield washer bottle (2) / bracket (1) onto the engine door bracket. (Fig. 2)
7. Use an existing hex screw / Belleville washer to connect the windshield washer bottle (2) ground wire to the engine door bracket. (Fig. 1)



FIG. 1

8. Connect the main wire harness to the windshield washer bottle (2) cable.
9. Connect the water tube to the windshield washer bottle (2).
10. Fill the windshield washer bottle (2) with windshield washer fluid.
11. Reconnect the battery cables to the battery.
12. Start and test the machine. Operate the windshield wiper washer to ensure the windshield wiper fluid is being sprayed onto the windshield when the windshield wiper fluid when the switch is activated.

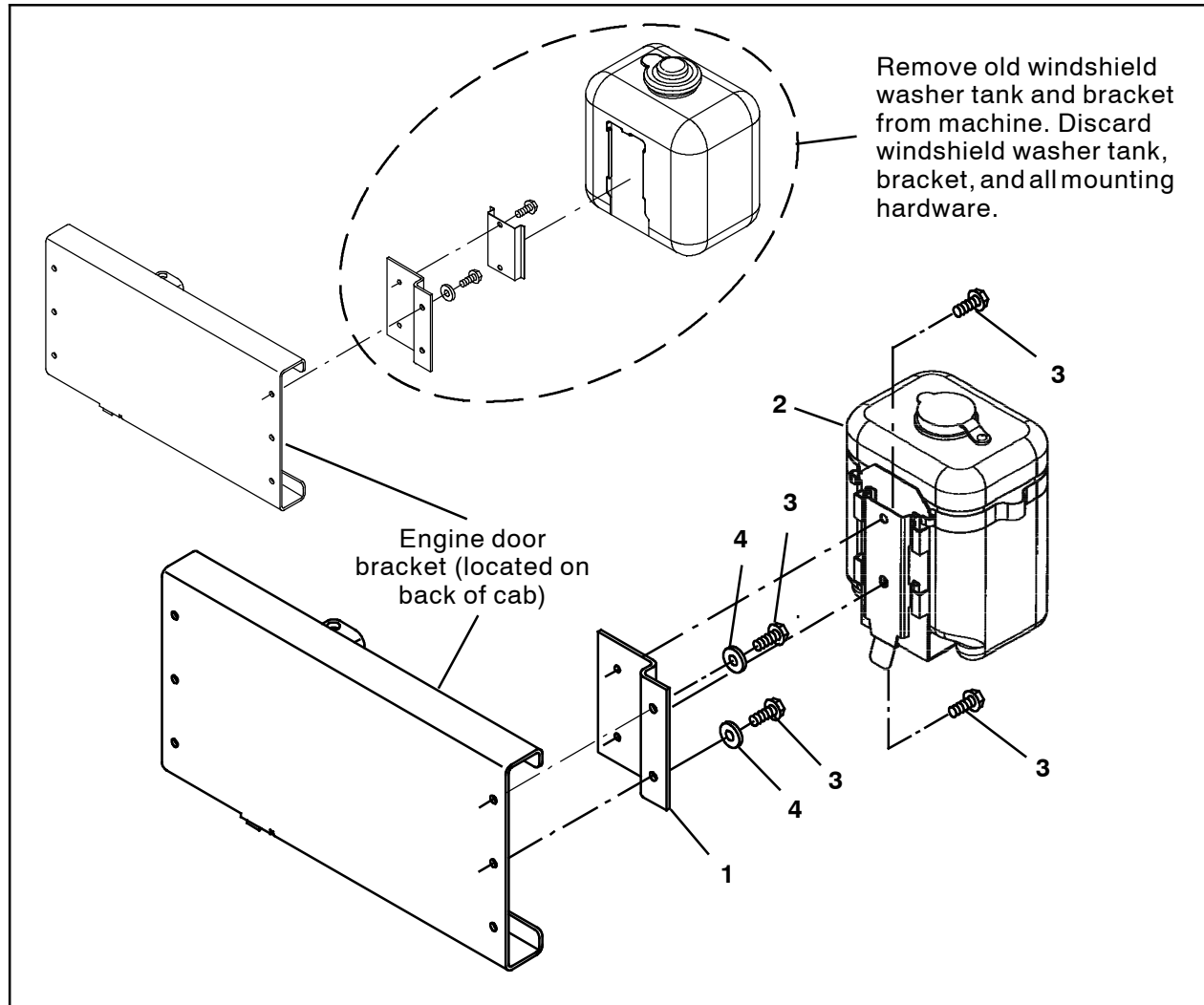

FIG. 2

Bill Of Materials For Bottle Kit, Washer Fluid Replmt - 9013078

Ref.	Tennant Part No.	Description	Qty.
1	1073901	Bracket	1
2	1074082	Tank, Fluid, Windshield Washer	1
3	12459	Screw, Hex, M6 X 1.00 X 20, Fmg	4
4	763040	Washer, Flat, Belleville, M6	2

TENNANT COMPANY
P. O. Box 1452
Minneapolis, MN 55440-1452